

since  
1976

# NAGEL

MAKİNA MOTOR  
İML. SAN. ve TİC. A.Ş.

## ÜRÜN KATALOĞU

### ASANSÖR MAKİNE VE MOTORLARI

PARS SERİSİ



KAYRA SERİSİ



DİŞLİSİZ SERİSİ



ÖZGEN SERİSİ



KLASİK SERİSİ





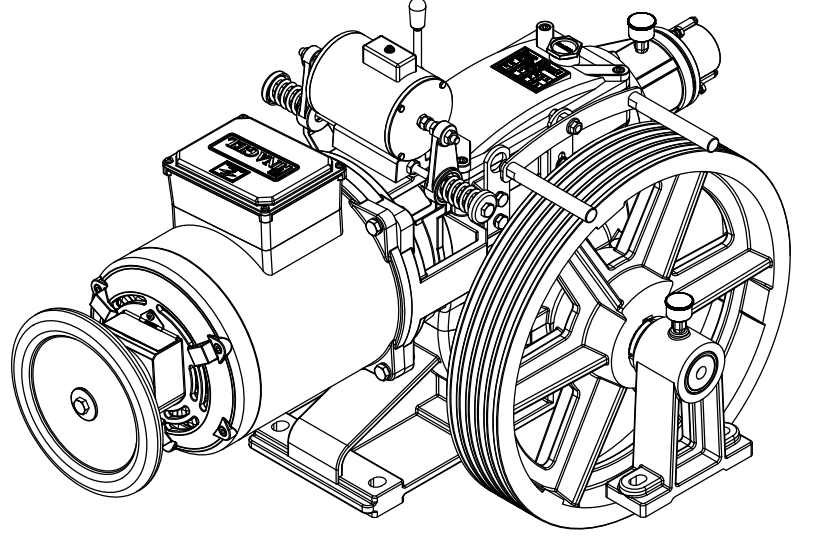

## Hakkımızda

**Nagel Makina Motor** 1976 yılında İstanbul'da kuruldu. 1981'den bu yana asansör makinası üreten firmamız, 1991 yılında çağın ve teknolojinin gereklerini yerine getirebileceği fabrika binasına taşınmış ve asansör motoru da üretmeye başlamıştır.

Teknoloji ve altyapı yatırımlarına devam ederek ürünlerimizi daha verimli hale getirmek ve çeşitlenen ihtiyaçlara daha iyi cevap verebilmek adına gerekli tüm yazılım ve üretim ekipmanlarını bünyesine katarak üretime devam etmiştir.

320 kg'dan 7 tona kadar kaldırma kapasiteli makina motor üretimine devam eden firmamız 2015 yılında dişlisiz motor satışına başlamıştır.

## Saygılarımızla

## About us

**Nagel Machine Engine** Production Industry and Trade Inc. has been working since 1976 to give the best product and service to the customers. Producing elevator machine since 1981, the company moved to its new factory where the new time and technology needs are covered in 1991, and then we started to produce elevator engine as well.

Continuing our investments for technology and substructure investments, we created our own R&D laboratory in 2003, all software and production equipments are added in order to have more efficient products and to be able to answer various needs.

Producing elevator machines and motors (from 320kg to 7000kg), our company started to produce gearless motors in 2015.

## Regards

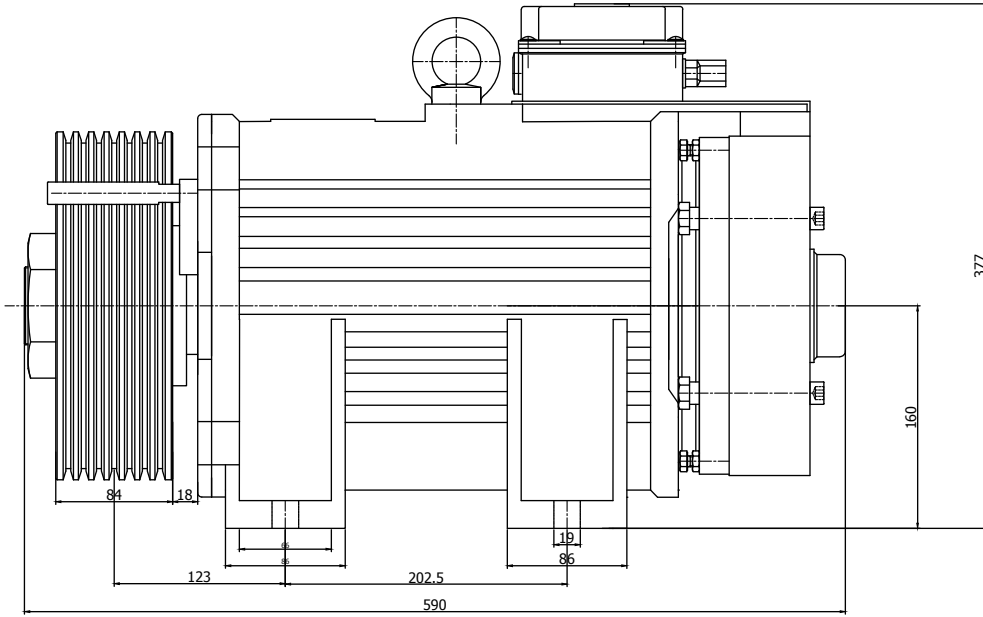
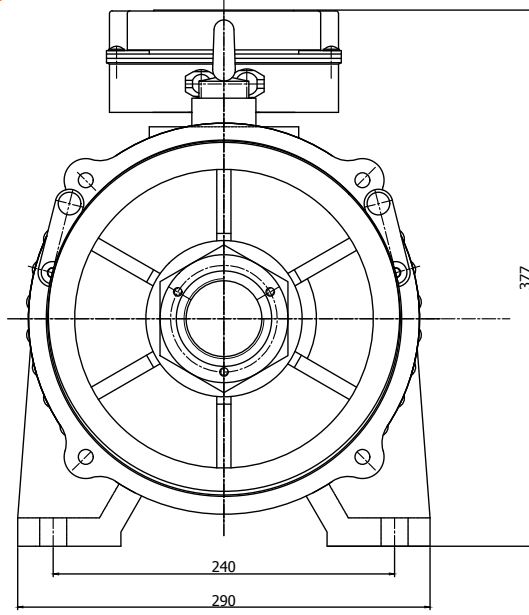

**DIRECTIVES :**  
 2014/33/EU Lift Directive 2014/35/  
 EU Low Voltage Directive 2006/42/  
 EC Machinery Directive

**STANDARTS :**  
 EN 81-20:2014

| MOTOR | YÜK    | MOTOR kW | AKIM    | HIZ     | ASKI       | KASNAK | H. SAYISI x ÇAP  | STATİK YÜK  | SEYİR MESAFESİ  |
|-------|--------|----------|---------|---------|------------|--------|------------------|-------------|-----------------|
| MOTOR | LOAD   | MOTOR kW | CURRENT | SPEED   | SUSPENSION | PULLEY | R. NUMBER x DIA. | STATIC LOAD | TRAVEL DISTANCE |
| ALP-2 | 630 KG | 5,2 kW   | 13,5 A  | 1 m/s   | 2 : 1      | 240 mm | 6 x 6,5 mm       | 3000 kg     | 33 m            |
| ALP-2 | 800 KG | 6,5 kW   | 16,5 A  |         |            |        | 7 x 6,5 mm       |             | 21 m            |
| ALP-2 | 630 KG | 7,4 kW   | 20,0 A  | 1,6 m/s |            |        | 6 x 6,5 mm       |             | 33 m            |

# ALP-2

Serisi / Series



**Not:**

a) Firmamız ürünlerinde haber vermeksizin değişiklik yapma hakkı saklıdır.

**Note:**

a) We reserve the right to change the terms and conditions.



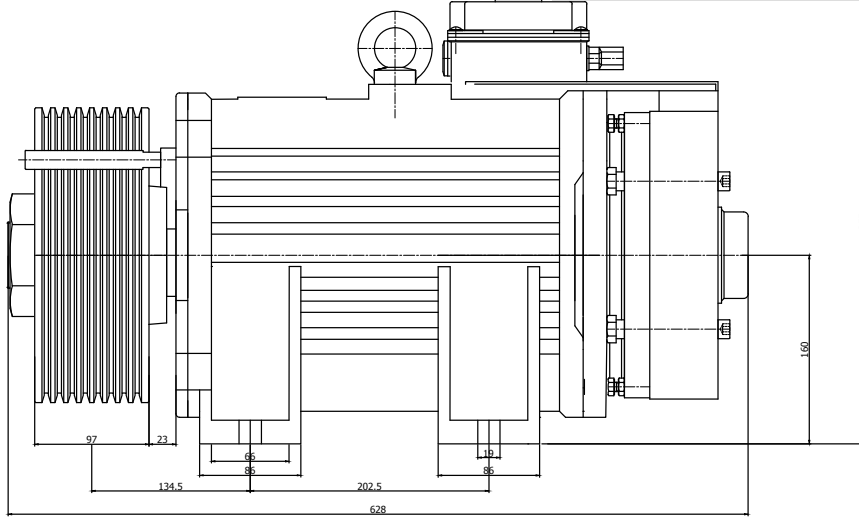
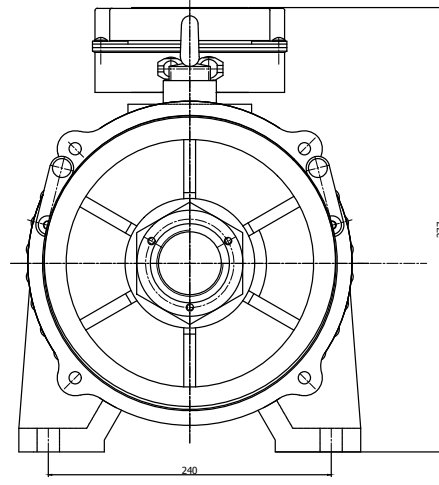

**DIRECTIVES :**  
 2014/33/EU Lift Directive 2014/35/  
 EU Low Voltage Directive 2006/42/  
 EC Machinery Directive

**STANDARTS :**  
 EN 81-20:2014

| MOTOR | YÜK     | MOTOR kW | AKIM    | HIZ     | ASKI       | KASNAK     | H. SAYISI x ÇAP  | STATİK YÜK  | SEYİR MESAFESİ  |
|-------|---------|----------|---------|---------|------------|------------|------------------|-------------|-----------------|
| MOTOR | LOAD    | MOTOR kW | CURRENT | SPEED   | SUSPENSION | PULLEY     | R. NUMBER x DIA. | STATIC LOAD | TRAVEL DISTANCE |
| ALP-3 | 630 KG  | 4,8 kW   | 13,5 A  | 1 m/s   | 2 : 1      | 240 mm     | 6 x 6,5 mm       | 3000 kg     | 51 m*           |
| ALP-3 | 800 KG  | 6,0 kW   | 16,5 A  |         |            |            | 7 x 6,5 mm       |             |                 |
| ALP-3 | 1000 KG | 8,5 kW   | 23,0 A  |         |            |            | 8 x 6,5 mm       |             |                 |
| ALP-3 | 630 KG  | 7,1 kW   | 15,0 A  | 1,6 m/s |            |            | 6 x 6,5 mm       |             | 51 m*           |
| ALP-3 | 800 KG  | 8,3 kW   | 19,0 A  |         |            |            | 7 x 6,5 mm       |             |                 |
| ALP-3 | 480 KG  | 7,5 kW   | 16,2 A  |         |            |            | 6 x 6,5 mm       |             |                 |
| ALP-3 | 630 KG  | 9,4 kW   | 19,3 A  | 2 m/s   |            | 7 x 6,5 mm |                  |             |                 |
| ALP-3 | 630 KG  | 6,4 kW   | 16,6 A  |         |            | 320 mm     | 5 x 8 mm         |             |                 |
| ALP-3 | 800 KG  | 9,2 kW   | 20,1 A  |         |            |            | 5 x 8 mm         |             |                 |
| ALP-3 | 630 KG  | 9,1 kW   | 18,5 A  | 1,6 m/s | 5 x 8 mm   |            |                  |             |                 |
| ALP-3 | 800 KG  | 12,3 kW  | 23,4 A  |         | 6 x 8 mm   |            |                  |             |                 |
| ALP-3 | 480 KG  | 8,1 kW   | 19,5 A  |         | 4 x 8 mm   |            |                  |             |                 |
| ALP-3 | 630 KG  | 11,5 kW  | 27,1 A  | 2 m/s   | 5 x 8 mm   |            |                  |             |                 |

\* denge zincirsiz  
 \* without balance chain

# ALP-3

Serisi / Series



**Not:**

a) Firmamız ürünlerinde haber vermeksizin değişiklik yapma hakkı saklıdır.

**Note:**

a) We reserve the right to change the terms and conditions.



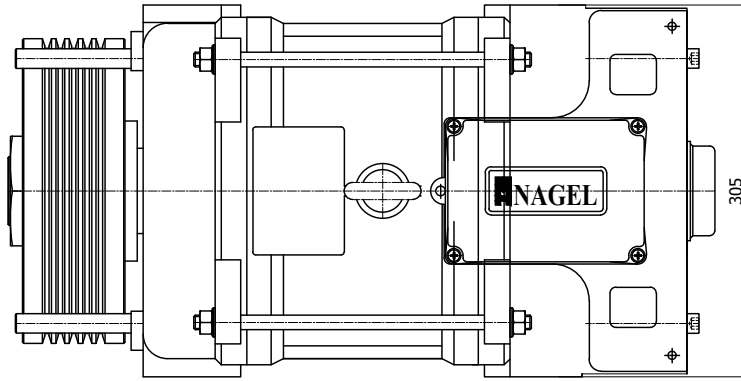
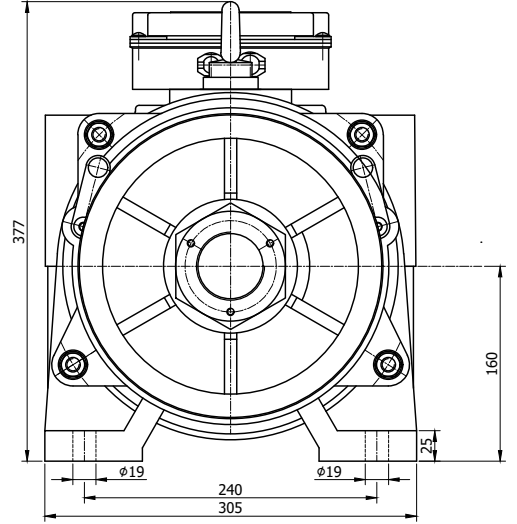
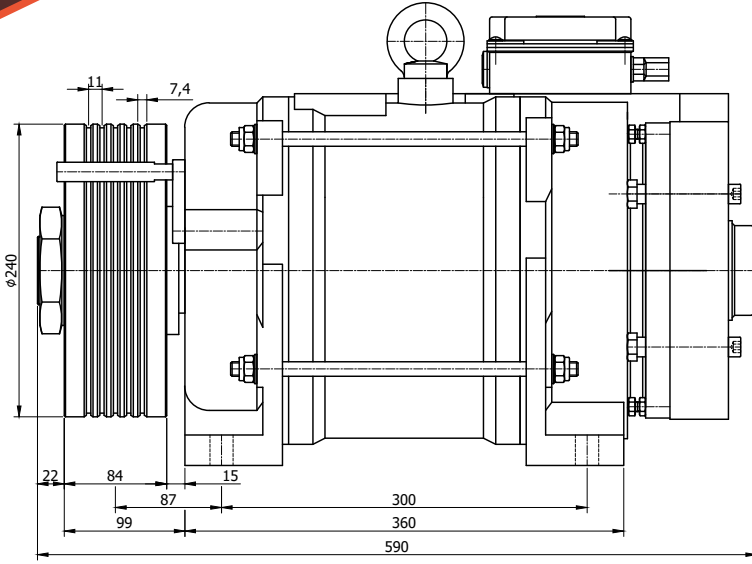

**DIRECTIVES :**  
 2014/33/EU Lift Directive 2014/35/  
 EU Low Voltage Directive 2006/42/  
 EC Machinery Directive

**STANDARDS :**  
 EN 81-20:2014

| MOTOR<br>MOTOR | YÜK<br>LOAD | MOTOR kW<br>MOTOR kW | AKIM<br>CURRENT | HIZ<br>SPEED | ASKI<br>SUSPENSION | KASNAK<br>PULLEY | H. SAYISI x ÇAP<br>R. NUMBER x DIA. | STATİK YÜK<br>STATIC LOAD | SEYİR MESAFESİ<br>TRAVEL DISTANCE |
|----------------|-------------|----------------------|-----------------|--------------|--------------------|------------------|-------------------------------------|---------------------------|-----------------------------------|
| NAGEL.160-2    | 400 KG      | 3,4 kW               | 8,0 A           | 1 m/s        | 2:1                | 240 mm           | 5 x 6.5 mm                          | 3000 kg                   | 51 m *                            |
| NAGEL.160-2    | 480 KG      | 4,3 kW               | 9,5 A           |              |                    |                  | 5 x 6.5 mm                          |                           |                                   |
| NAGEL.160-2    | 400 KG      | 5,2 kW               | 9,6 A           | 1,6 m/s      |                    |                  | 5 x 6.5 mm                          |                           |                                   |
| NAGEL.160-2    | 480 KG      | 6,3 kW               | 10,5 A          |              |                    |                  | 5 x 6.5 mm                          |                           |                                   |
| NAGEL.160-2    | 400 KG      | 4,7 kW               | 9,5 A           | 1 m/s        |                    | 320 mm           | 4 x 8 mm                            |                           |                                   |
| NAGEL.160-2    | 480 KG      | 5,7 kW               | 11,4 A          |              |                    |                  | 4 x 8 mm                            |                           |                                   |
| NAGEL.160-2    | 400 KG      | 7,2 kW               | 11,2 A          | 1,6 m/s      |                    |                  | 4 x 8 mm                            |                           |                                   |
| NAGEL.160-2    | 480 KG      | 8,3 kW               | 14,5 A          |              |                    |                  | 4 x 8 mm                            |                           |                                   |

\* denge zincirsiz  
 \* without balance chain

# Dişlisiz/Gearless 160-2

Serisi / Series



**Not:**

- a) 2:1 Askıda 51 metreden sonra denge zinciri kullanılmalıdır.
- b) Firmamız ürünlerinde haber vermeksizin değişiklik yapma hakkı saklıdır.

**Note:**

- a) Elevator balance compensation chain should be used when the distance is higher than 51 m.
- c) We reserve the right to change the terms and conditions.



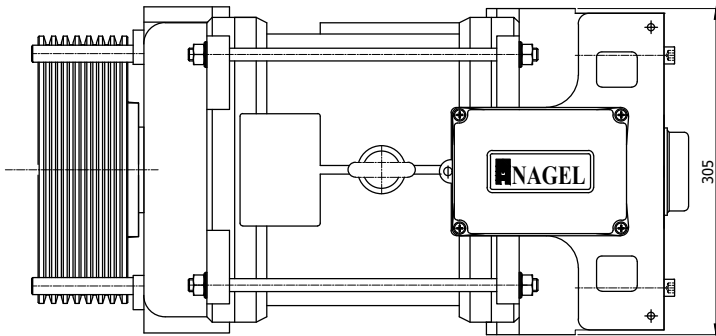
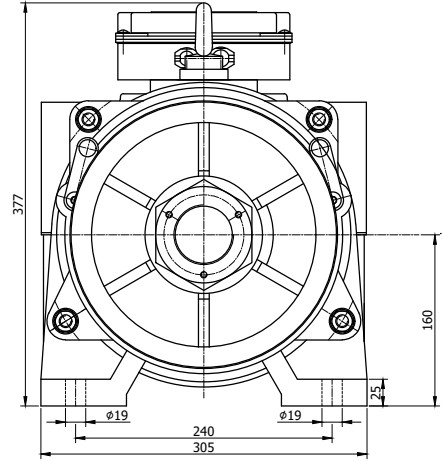
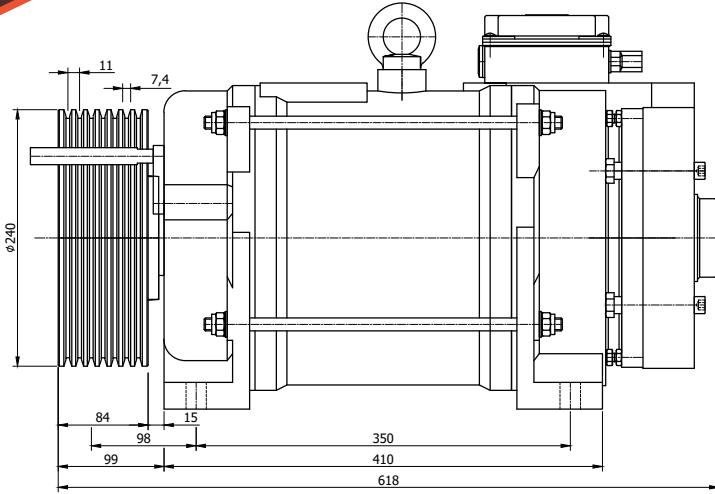

**DIRECTIVES :**  
 2014/33/EU Lift Directive 2014/35/  
 EU Low Voltage Directive 2006/42/  
 EC Machinery Directive

**STANDARTS :**  
 EN 81-20:2014

| MAKİNE<br>MACHINE | YÜK<br>LOAD | MOTOR kW<br>MOTOR kW | AKIM<br>CURRENT | HIZ<br>SPEED | ASKI<br>SUSPENSION | KASNAK<br>PULLEY | H. SAYISI x ÇAP<br>R. NUMBER x DIA. | STATİK YÜK<br>STATIC LOAD | SEYİR MESAFESİ<br>TRAVEL DISTANCE |
|-------------------|-------------|----------------------|-----------------|--------------|--------------------|------------------|-------------------------------------|---------------------------|-----------------------------------|
| NAGEL.160-3       | 630 KG      | 4,8 kW               | 13,5 A          | 1 m/s        | 2 : 1              | 240 mm           | 6 x 6,5 mm                          | 3000 kg                   | 51 m *                            |
| NAGEL.160-3       | 800 KG      | 6,0 kW               | 16,5 A          |              |                    |                  | 7 x 6,5 mm                          |                           |                                   |
| NAGEL.160-3       | 630 KG      | 7,1 kW               | 15,0 A          | 1,6 m/s      |                    |                  | 6 x 6,5 mm                          |                           |                                   |
| NAGEL.160-3       | 800 KG      | 8,3 kW               | 19,0 A          |              |                    |                  | 7 x 6,5 mm                          |                           |                                   |
| NAGEL.160-3       | 480 KG      | 7,5 kW               | 16,2 A          | 2 m/s        |                    |                  | 6 x 6,5 mm                          |                           |                                   |
| NAGEL.160-3       | 630 KG      | 9,4 kW               | 19,3 A          |              |                    |                  | 7 x 6,5 mm                          |                           |                                   |
| NAGEL.160-3       | 630 KG      | 6,4 kW               | 16,6 A          | 1 m/s        |                    | 320 mm           | 5 x 8 mm                            |                           |                                   |
| NAGEL.160-3       | 800 KG      | 9,2 kW               | 20,1 A          |              |                    |                  | 5 x 8 mm                            |                           |                                   |
| NAGEL.160-3       | 630 KG      | 9,1 kW               | 18,5 A          | 1,6 m/s      |                    |                  | 5 x 8 mm                            |                           |                                   |
| NAGEL.160-3       | 800 KG      | 12,3 kW              | 23,4 A          |              |                    |                  | 5 x 8 mm                            |                           |                                   |
| NAGEL.160-3       | 480 KG      | 8,1 kW               | 19,5 A          | 2 m/s        |                    |                  | 4 x 8 mm                            |                           |                                   |
| NAGEL.160-3       | 630 KG      | 11,5 kW              | 27,1 A          |              |                    |                  | 5 x 8 mm                            |                           |                                   |

\* denge zincirsiz  
 \* without balance chain

# Dişlisiz/Gearless 160-3

Serisi / Series



**Not:**

- a) 2:1 Askıda 51 metreden sonra denge zinciri kullanılmalıdır.
- b) Firmamız ürünlerinde haber vermeksizin değişiklik yapma hakkı saklıdır.

**Note:**

- a) Elevator balance compensation chain should be used when the distance is higher than 51 m.
- c) We reserve the right to change the terms and conditions.



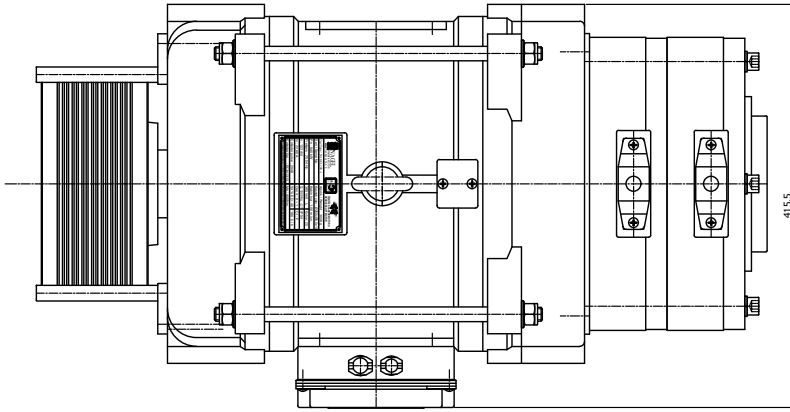
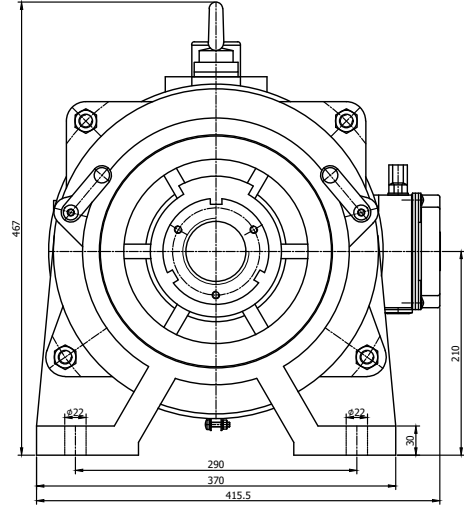
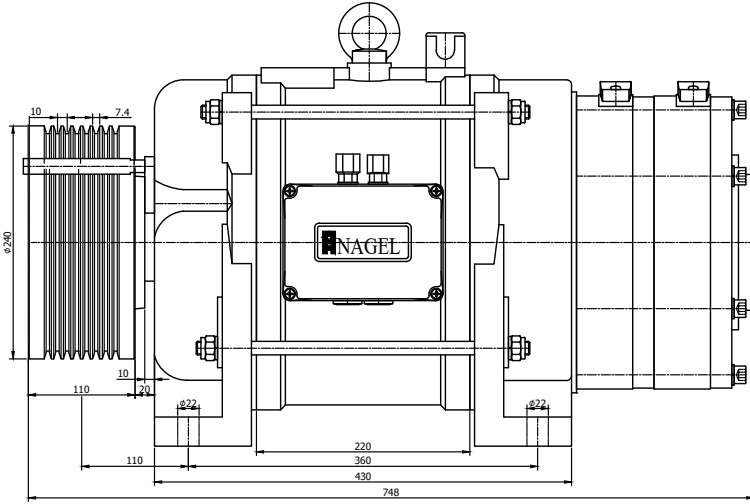

**DIRECTIVES :**  
 2014/33/EU Lift Directive 2014/35/  
 EU Low Voltage Directive 2006/42/  
 EC Machinery Directive

**STANDARTS :**  
 EN 81-20:2014

| MAKİNE<br>MACHINE | YÜK<br>LOAD | MOTOR kW<br>MOTOR kW | AKIM<br>CURRENT | HIZ<br>SPEED | ASKI<br>SUSPENSION | KASNAK<br>PULLEY | H. SAYISI x ÇAP<br>R. NUMBER x DIA. | STATİK YÜK<br>STATIC LOAD | SEYİR MESAFESİ<br>TRAVEL DISTANCE |
|-------------------|-------------|----------------------|-----------------|--------------|--------------------|------------------|-------------------------------------|---------------------------|-----------------------------------|
| NAGEL.200-1       | 1000 KG     | 7,8 kW               | 20,2 A          | 1 m/s        | 2 : 1              | 240 mm           | 8 x 6,5 mm                          | 3700 kg                   | 51 m *                            |
| NAGEL.200-1       | 1000 KG     | 10,8 kW              | 23,5 A          | 1,6 m/s      |                    |                  | 8 x 6,5 mm                          |                           |                                   |
| NAGEL.200-1       | 800 KG      | 11,8 kW              | 19,8 A          | 2 m/s        |                    |                  | 8 x 6,5 mm                          |                           |                                   |
| NAGEL.200-1       | 800 KG      | 8,0 kW               | 21,4 A          | 1 m/s        |                    | 320 mm           | 5 x 8 mm                            |                           |                                   |
| NAGEL.200-1       | 1000 KG     | 12,7 kW              | 31,7 A          |              |                    |                  | 7 x 8 mm                            |                           |                                   |
| NAGEL.200-1       | 800 KG      | 10,9 kW              | 23,0 A          | 1,6 m/s      |                    | 6 x 8 mm         |                                     |                           |                                   |
| NAGEL.200-1       | 1000 KG     | 17,2 kW              | 33,1 A          |              |                    | 7 x 8 mm         |                                     |                           |                                   |
| NAGEL.200-1       | 800 KG      | 12,8 kW              | 21,2 A          |              |                    | 2 m/s            | 6 x 8 mm                            |                           |                                   |

\* denge zincirsiz  
 \* without balance chain

# Dislisiz/Gearless 200-1

Serisi / Series



**Not:**

- a) 2:1 Askıda 51 metreden sonra denge zinciri kullanılmalıdır.
- b) Firmamız ürünlerinde haber vermeksizin değişiklik yapma hakkı saklıdır.

**Note:**

- a) Elevator balance compensation chain should be used when the distance is higher than 51 m.
- c) We reserve the right to change the terms and conditions.



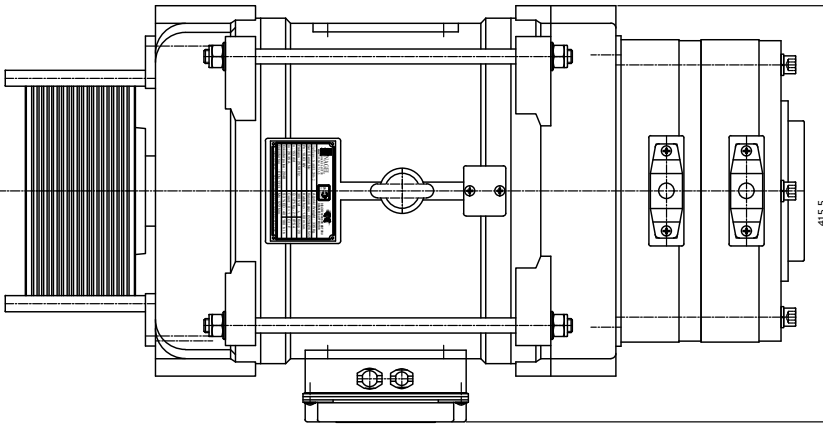
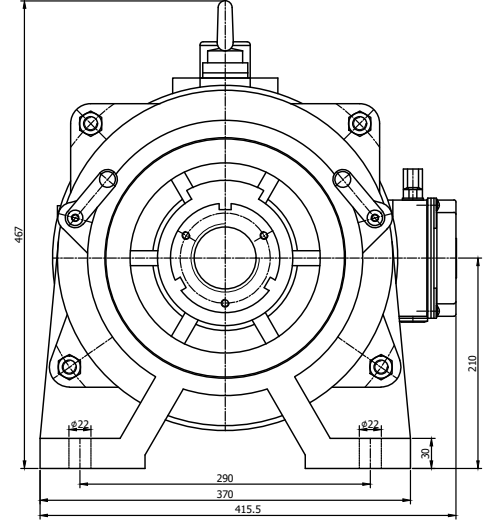
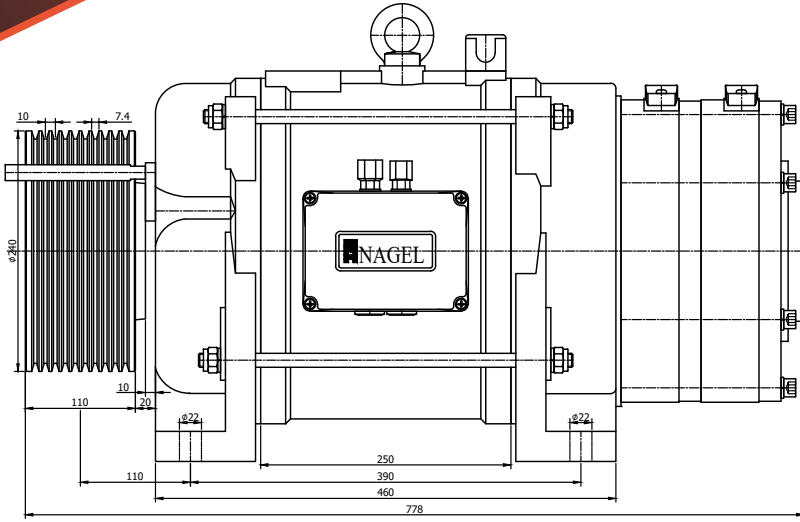

**DIRECTIVES :**  
2014/33/EU Lift Directive 2014/35/  
EU Low Voltage Directive 2006/42/  
EC Machinery Directive

**STANDARTS :**  
EN 81-20:2014

| MAKİNE<br>MACHINE | YÜK<br>LOAD | MOTOR kW<br>MOTOR kW | AKIM<br>CURRENT | HIZ<br>SPEED | ASKI<br>SUSPENSION | KASNAK<br>PULLEY | H. SAYISI x ÇAP<br>R. NUMBER x DIA. | STATİK YÜK<br>STATIC LOAD | SEYİR MESAFESİ<br>TRAVEL DISTANCE |
|-------------------|-------------|----------------------|-----------------|--------------|--------------------|------------------|-------------------------------------|---------------------------|-----------------------------------|
| NAGEL.200-2       | 1300 KG     | 9,6 kW               | 24,1 A          | 1 m/s        | 2 : 1              | 240 mm           | 10 x 6,5 mm                         | 3700 kg                   | 51 m *                            |
| NAGEL.200-2       | 1300 KG     | 13,2 kW              | 27,5 A          | 1,6 m/s      |                    |                  | 10 x 6,5 mm                         |                           |                                   |
| NAGEL.200-2       | 1000 KG     | 15,1 kW              | 29,2 A          | 2 m/s        |                    |                  | 10 x 6,5 mm                         |                           |                                   |
| NAGEL.200-2       | 1000 KG     | 9,9 kW               | 25,5 A          | 1 m/s        |                    | 320 mm           | 7 x 8 mm                            |                           |                                   |
| NAGEL.200-2       | 1300 KG     | 15,7 kW              | 33,7 A          | 1,6 m/s      |                    |                  | 7 x 8 mm                            |                           |                                   |
| NAGEL.200-2       | 1000 KG     | 14,5 kW              | 28,2 A          |              |                    |                  | 7 x 8 mm                            |                           |                                   |
| NAGEL.200-2       | 1300 KG     | 18,2 kW              | 36,1 A          | 2 m/s        |                    |                  | 7 x 8 mm                            |                           |                                   |
| NAGEL.200-2       | 1000 KG     | 16,5 kW              | 32,3 A          |              |                    |                  | 7 x 8 mm                            |                           |                                   |

\* denge zincirsiz  
\* without balance chain

# Dislisiz/Gearless 200-2

Serisi / Series



**Not:**

- a) 2:1 Askıda 51 metreden sonra denge zinciri kullanılmalıdır.
- b) Firmamız ürünlerinde haber vermeksizin değişiklik yapma hakkı saklıdır.

**Note:**

- a) Elevator balance compensation chain should be used when the distance is higher than 51 m.
- c) We reserve the right to change the terms and conditions.



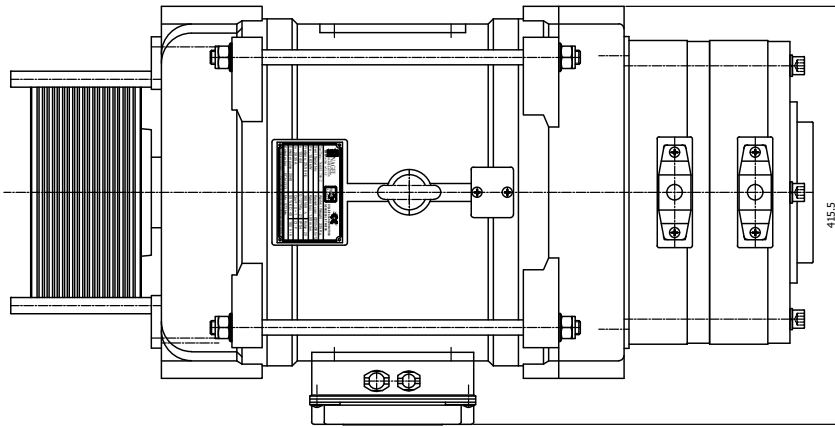
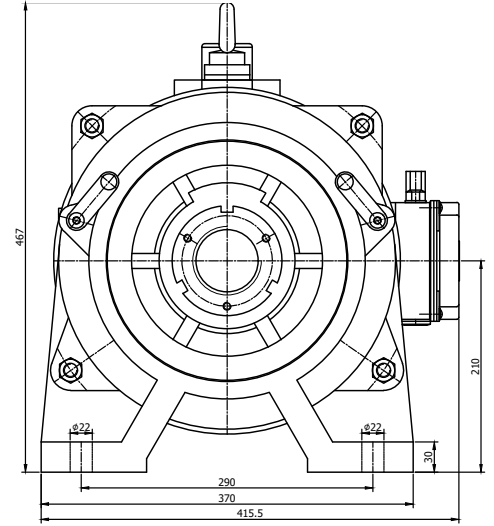
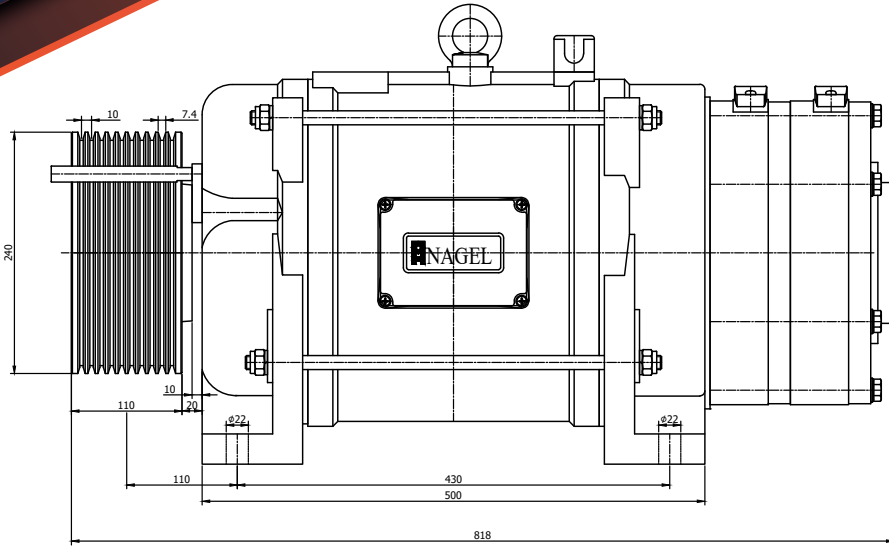

**DIRECTIVES :**  
 2014/33/EU Lift Directive 2014/35/  
 EU Low Voltage Directive 2006/42/  
 EC Machinery Directive

**STANDARTS :**  
 EN 81-20:2014

| MAKİNE<br>MACHINE | YÜK<br>LOAD | MOTOR kW<br>MOTOR kW | AKIM<br>CURRENT | HIZ<br>SPEED | ASKI<br>SUSPENSION | KASNAK<br>PULLEY | H. SAYISI x ÇAP<br>R. NUMBER x DIA. | STATİK YÜK<br>STATIC LOAD | SEYİR MESAFESİ<br>TRAVEL DISTANCE |
|-------------------|-------------|----------------------|-----------------|--------------|--------------------|------------------|-------------------------------------|---------------------------|-----------------------------------|
| NAGEL.200-3       | 1600 KG     | 12,1 kW              | 30,4 A          | 1 m/s        | 2 : 1              | 240 mm           | 10 x 6.5 mm                         | 4000 kg                   | 51 m *                            |
| NAGEL.200-3       | 1600 KG     | 16,4 kW              | 36,5 A          | 1,6 m/s      |                    |                  | 10 x 6.5 mm                         |                           |                                   |
| NAGEL.200-3       | 1600 KG     | 19,1 kW              | 37,0 A          | 2 m/s        |                    |                  | 10 x 6.5 mm                         |                           |                                   |
| NAGEL.200-3       | 1300 KG     | 12,2 kW              | 28,1 A          | 1 m/s        |                    | 320 mm           | 7 x 8 mm                            |                           |                                   |
| NAGEL.200-3       | 1600 KG     | 19,2 kW              | 39,5 A          |              |                    |                  | 7 x 8 mm                            |                           |                                   |
| NAGEL.200-3       | 1300 KG     | 18,2 kW              | 30,2 A          | 1,6 m/s      |                    |                  | 7 x 8 mm                            |                           |                                   |
| NAGEL.200-3       | 1600 KG     | 24,2 kW              | 43,2 A          |              |                    |                  | 7 x 8 mm                            |                           |                                   |
| NAGEL.200-3       | 1300 KG     | 20,1 kW              | 39,0 A          | 2 m/s        |                    | 7 x 8 mm         |                                     |                           |                                   |

\* denge zincirsiz  
 \* without balance chain

# Dislisiz/Gearless 200-3

Serisi / Series



**Not:**

- a) 2:1 Askıda 51 metreden sonra denge zinciri kullanılmalıdır.
- b) Firmamız ürünlerinde haber vermeksizin değişiklik yapma hakkı saklıdır.

**Note:**

- a) Elevator balance compensation chain should be used when the distance is higher than 51 m.
- c) We reserve the right to change the terms and conditions.

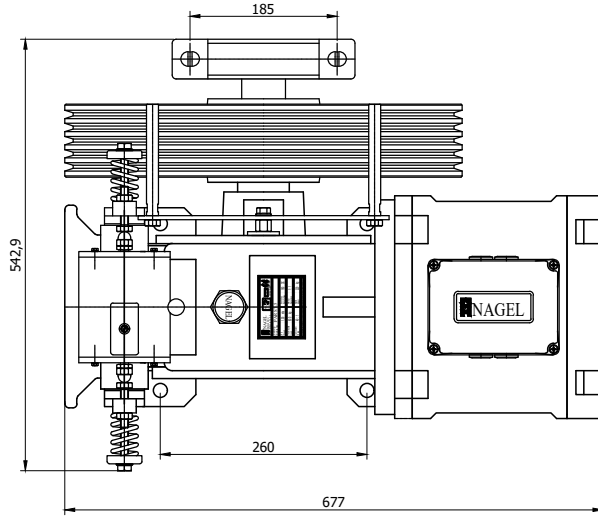
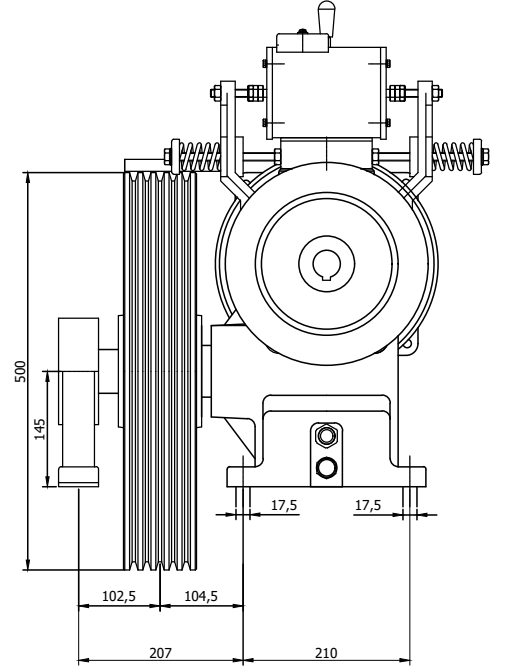
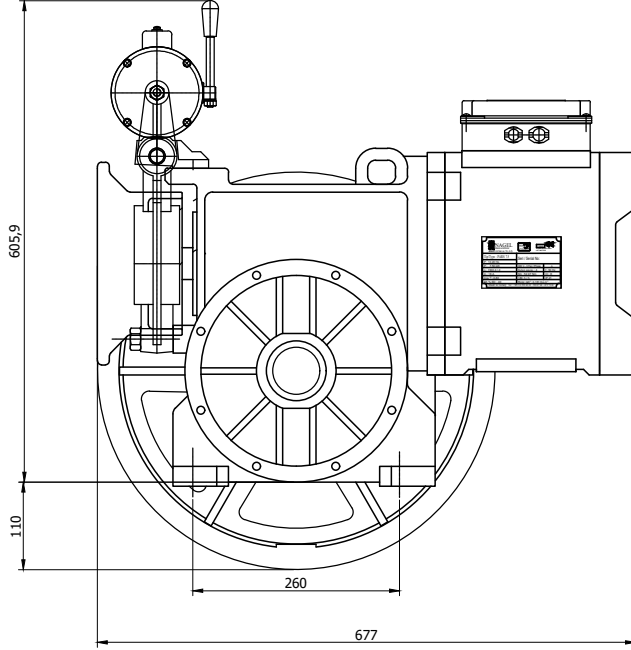

**DIRECTIVES :**

2014/33/EU Lift Directive 2014/35/  
 EU Low Voltage Directive 2006/42/  
 EC Machinery Directive

**STANDARDS :**

"EN 81-20:2014  
 EN ISO 12100:2010  
 EN 349:1993+A1:2008  
 EN 614-1:2006+A1:2009  
 EN 60204-1:2006  
 EN ISO 13857:2008"

| MAKİNE<br>MACHINE | MOTOR<br>MOTOR           | YÜK<br>LOAD | MOTOR kW<br>MOTOR kW | AKIM<br>CURRENT | HIZ<br>SPEED | ASKI<br>SUSPENSION | TAHVİL<br>RATIO | KASNAK<br>PULLEY | H. SAYISI x ÇAP<br>R. NUMBER x DIA. | STATİK YÜK<br>STATIC LOAD | SEYİR MESAFESİ<br>TRAVEL DISTANCE |
|-------------------|--------------------------|-------------|----------------------|-----------------|--------------|--------------------|-----------------|------------------|-------------------------------------|---------------------------|-----------------------------------|
| PARS 5.5          | VVVF                     | 630 KG      | 5,5 kW               | 13 A            | 1 m/s        | 1 : 1              | 40 : 1          | 500 mm           | 5 x 10 mm                           | 5000 kg                   | 30 m*                             |
| PARS 7.5          | VVVF                     | 800 KG      | 7,5 kW               | 17 A            |              |                    |                 |                  | 4 x 10 mm                           |                           |                                   |
| PARS 6.25 DS      | ÇİFT HIZ DOUBLE<br>SPEED | 450 KG      | 6.25kW /<br>1.5kW    | 15,8 A /11 A    |              |                    |                 |                  | 5 x 10 mm                           |                           |                                   |
| PARS 7.5 DS       | ÇİFT HIZ DOUBLE<br>SPEED | 630 KG      | 7,5kW / 1.8kW        | 18 A /10 A      | 0.8 m/s      | 55 : 1             | 550 mm          | 4 x 10 mm        | 5000 kg                             | 30 m*                     |                                   |
| PARS 6.25<br>DS2  | ÇİFT HIZ DOUBLE<br>SPEED | 450 KG      | 6.25kW /<br>1.5kW    | 15,8 A /11 A    |              |                    |                 | 5 x 10 mm        |                                     |                           |                                   |
| PARS 7.5 DS2      | ÇİFT HIZ DOUBLE<br>SPEED | 630 KG      | 7,5kW / 1.8kW        | 18 A /10 A      |              |                    |                 | 5 x 10 mm        |                                     |                           |                                   |

\* denge zincirsiz  
 \* without balance chain

# Pars

Serisi / Series



**Not:**

- a) Tahrir kasmađı mil apı Ø 64 mm
- b) Makine iin nerilen yađ kullanılmaması,yatakların,dışlinin aşınmasına ve makine verim kaybına neden olur
- c) Firmamız rnlerinde haber vermeksizin deđişiklik yapma hakkı saklıdır.

**Note:**

- a) Driving pulley shaft diameter is Ø 64 mm
- b) Recommended lubricant must be used otherwise the bearings and gears mounted on speed reducer will be wearen faster and the efficiency will decreased.
- c) We reserve the right to change the terms and conditions.



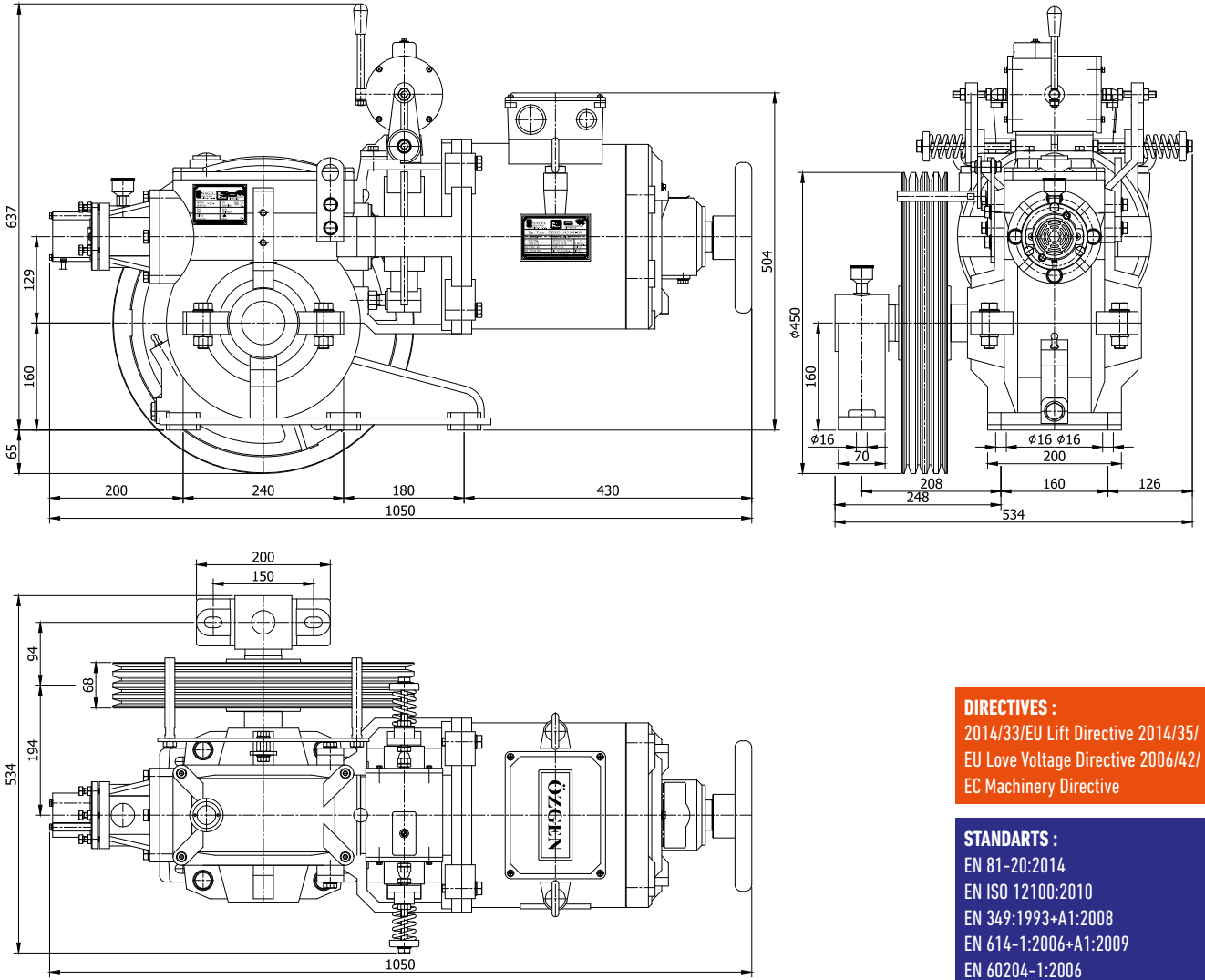

**DIRECTIVES :**  
2014/33/EU Lift Directive 2014/35/  
EU Low Voltage Directive 2006/42/  
EC Machinery Directive

**STANDARDS :**  
EN 81-20:2014  
EN ISO 12100:2010  
EN 349:1993+A1:2008  
EN 614-1:2006+A1:2009  
EN 60204-1:2006  
EN ISO 13857:2008

| MAKİNE<br>MACHINE | MOTOR<br>MOTOR              | YÜK<br>LOAD | MOTOR kW<br>MOTOR kW | AKIM<br>CURRENT | HIZ<br>SPEED | ASKI<br>SUSPENSION | TAHVİL<br>RATIO | KASNAK<br>PULLEY | H. SAYISI x ÇAP<br>R. NUMBER x DIA. | STATİK YÜK<br>STATIC LOAD | SEYİR MESAFESİ<br>TRAVEL DISTANCE |
|-------------------|-----------------------------|-------------|----------------------|-----------------|--------------|--------------------|-----------------|------------------|-------------------------------------|---------------------------|-----------------------------------|
| ÖZGEN.2           | VVVF                        | 400 KG      | 5,5 kW               | 13 A            | 1 m/s        | 1 : 1              | 35 : 1          | 450 mm           | 4 x 10 mm                           | 4000 kg                   | 30 m (*60 m)                      |
| ÖZGEN.2           | VVVF                        | 480 KG      | 6,25 kW              | 16 A            |              |                    |                 |                  |                                     |                           |                                   |
| ÖZGEN.2           | ÇİFT HIZ<br>DOUBLE<br>SPEED | 400 KG      | 6.25kW /<br>1.5kW    | 15,8 A /11 A    |              |                    |                 |                  |                                     |                           |                                   |

\* denge zinciri ile  
\* with balance chain

# Özgen-2

Serisi / Series

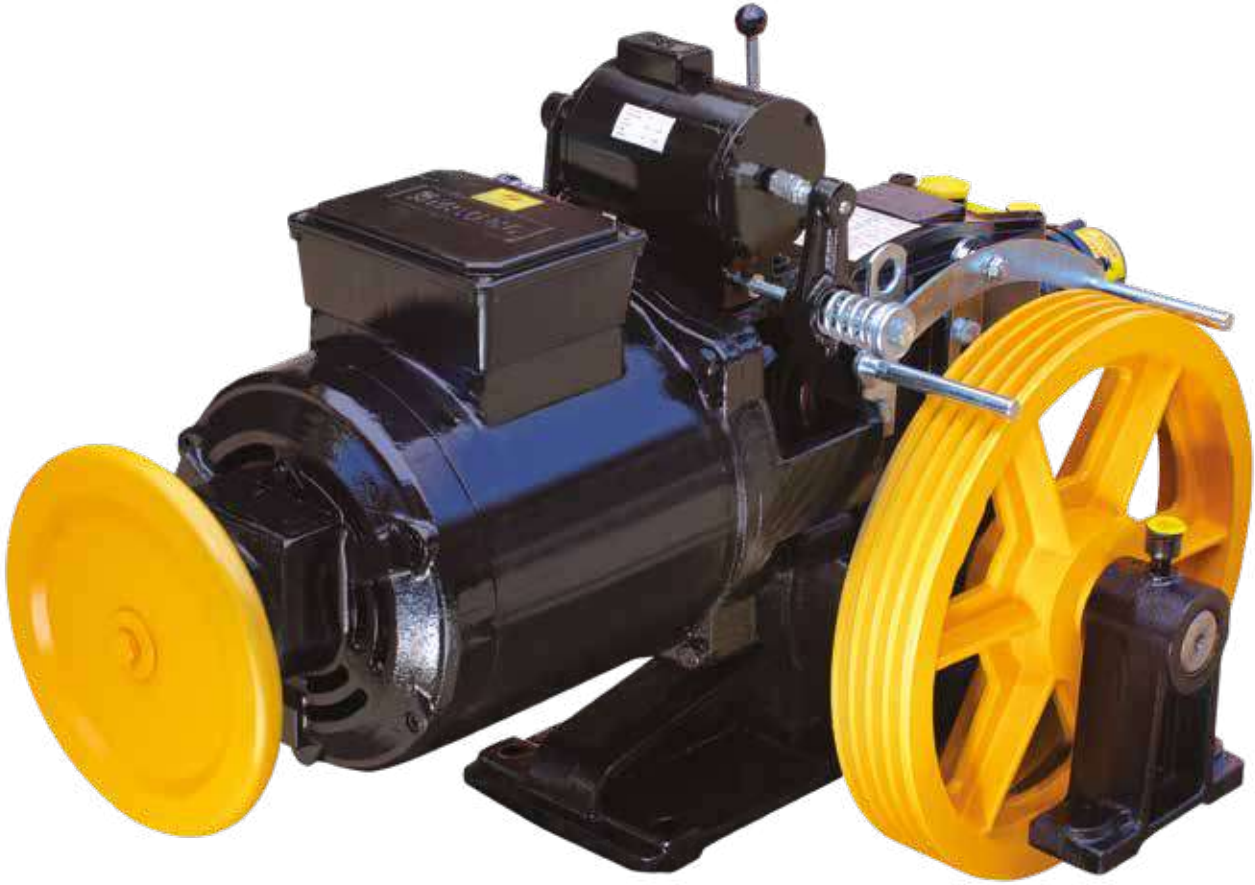

**Not:**

- a) Tahrik kasnağı mil çapı  $\varnothing$  55 mm
- b) Makine için önerilen yağ kullanılmaması, yatakların, dişlinin aşınmasına ve makine verim kaybına neden olur.
- c) Firmamız ürünlerinde haber vermeksizin değişiklik yapma hakkı saklıdır.

**Note:**

- a) Driving pulley shaft diameter is  $\varnothing$  55 mm
- b) Recommended gear oil must be used otherwise the journal bearings and the gear will be worn out and the efficiency will decrease.
- c) We reserve the right to change the terms and conditions.

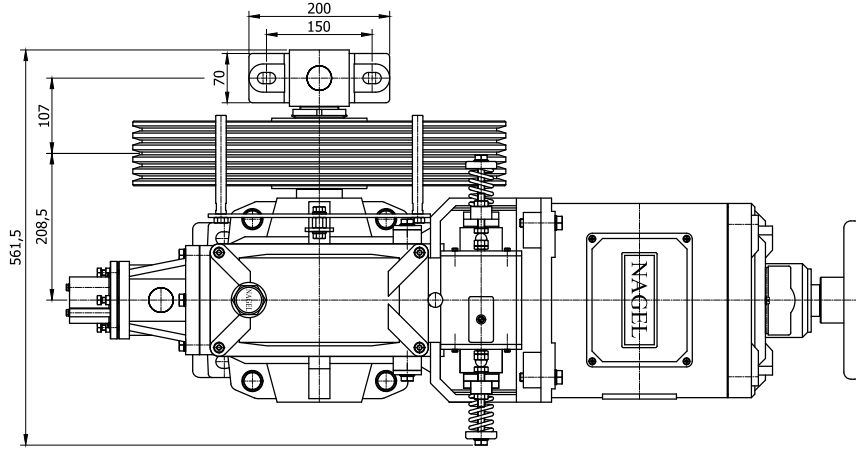
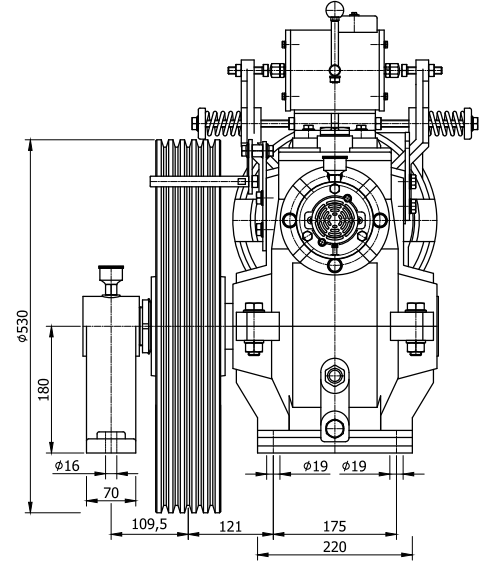
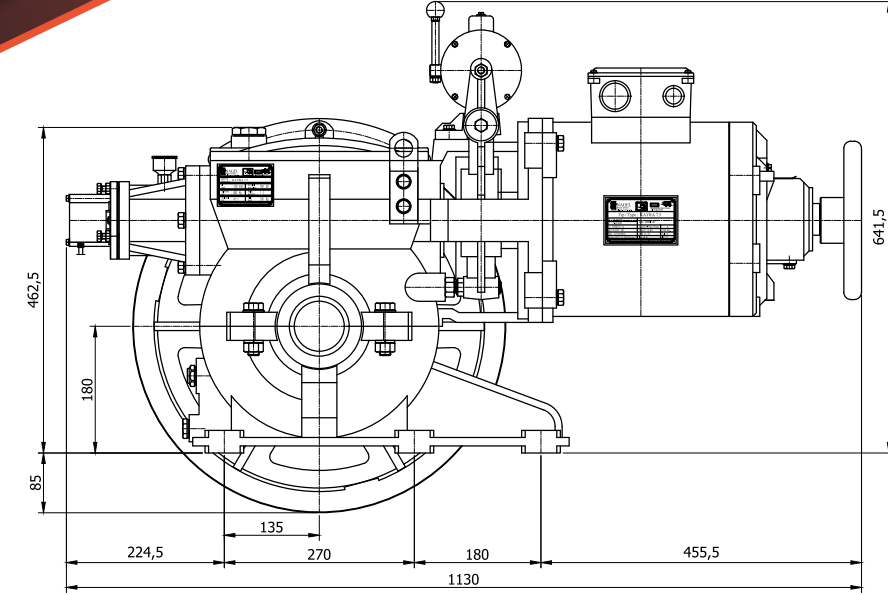

**DIRECTIVES :**

2014/33/EU Lift Directive 2014/35/  
 EU Low Voltage Directive 2006/42/  
 EC Machinery Directive

**STANDARTS :**

EN 81-20:2014  
 EN ISO 12100:2010  
 EN 349:1993+A1:2008  
 EN 614-1:2006+A1:2009  
 EN 60204-1:2006  
 EN ISO 13857:2008

| MAKİNE<br>MACHINE | MOTOR<br>MOTOR              | YÜK<br>LOAD | MOTOR kW<br>MOTOR kW | AKIM<br>CURRENT | HIZ<br>SPEED | ASKI<br>SUSPENSION | TAHVİL<br>RATIO | KASNAK<br>PULLEY | H. SAYISI x ÇAP<br>R. NUMBER x DIA. | STATİK YÜK<br>STATIC LOAD | SEYİR MESAFESİ<br>TRAVEL DISTANCE |
|-------------------|-----------------------------|-------------|----------------------|-----------------|--------------|--------------------|-----------------|------------------|-------------------------------------|---------------------------|-----------------------------------|
| KAYRA 5.5         | VVVF                        | 630 KG      | 5,5 kW               | 13 A            | 1 m/s        | 1 : 1              | 41 : 1          | 530 mm           | 5 x 10 mm                           | 5000 kg                   | 30 m (*60 m)                      |
| KAYRA 7.5         | ÇİFT HIZ<br>DOUBLE<br>SPEED | 500 KG      | 7,5kW /<br>1.8kW     | 18 A /10 A      |              |                    |                 |                  |                                     |                           |                                   |
| KAYRA 7.5         | VVVF                        | 630         | 7,5 kW               | 17 A            |              |                    |                 |                  |                                     |                           |                                   |
| KAYRA 7.5         | VVVF                        | 800         | 7,5 kW               | 17 A            |              |                    |                 |                  |                                     |                           |                                   |
| KAYRA 9.2         | ÇİFT HIZ<br>DOUBLE<br>SPEED | 630 KG      | 9,2kW /<br>2,3kW     | 23 A<br>/13,5 A |              |                    |                 |                  |                                     |                           |                                   |
| KAYRA 9.2         | VVVF                        | 800 KG      | 9,2 kW               | 23 A            |              |                    |                 |                  |                                     |                           |                                   |

\* denge zinciri ile  
 \* with balance chain

# Kayra

Serisi / Series



**Not:**

- a) Tahrir kasnağı mil çapı  $\varnothing$  64 mm
- b) Makine için önerilen yağ kullanılmaması,yatakların,dişlinin aşınmasına ve makine verim kaybına neden olur.
- c) Firmamız ürünlerinde haber vermeksizin değişiklik yapma hakkı saklıdır.

**Note:**

- a) Driving pulley shaft diameter is  $\varnothing$  64 mm
- b) Recommended gear oil must be used otherwise the journal bearings and the gear will be worn out and the efficiency will decrease.
- c) We reserve the right to change the terms and conditions.



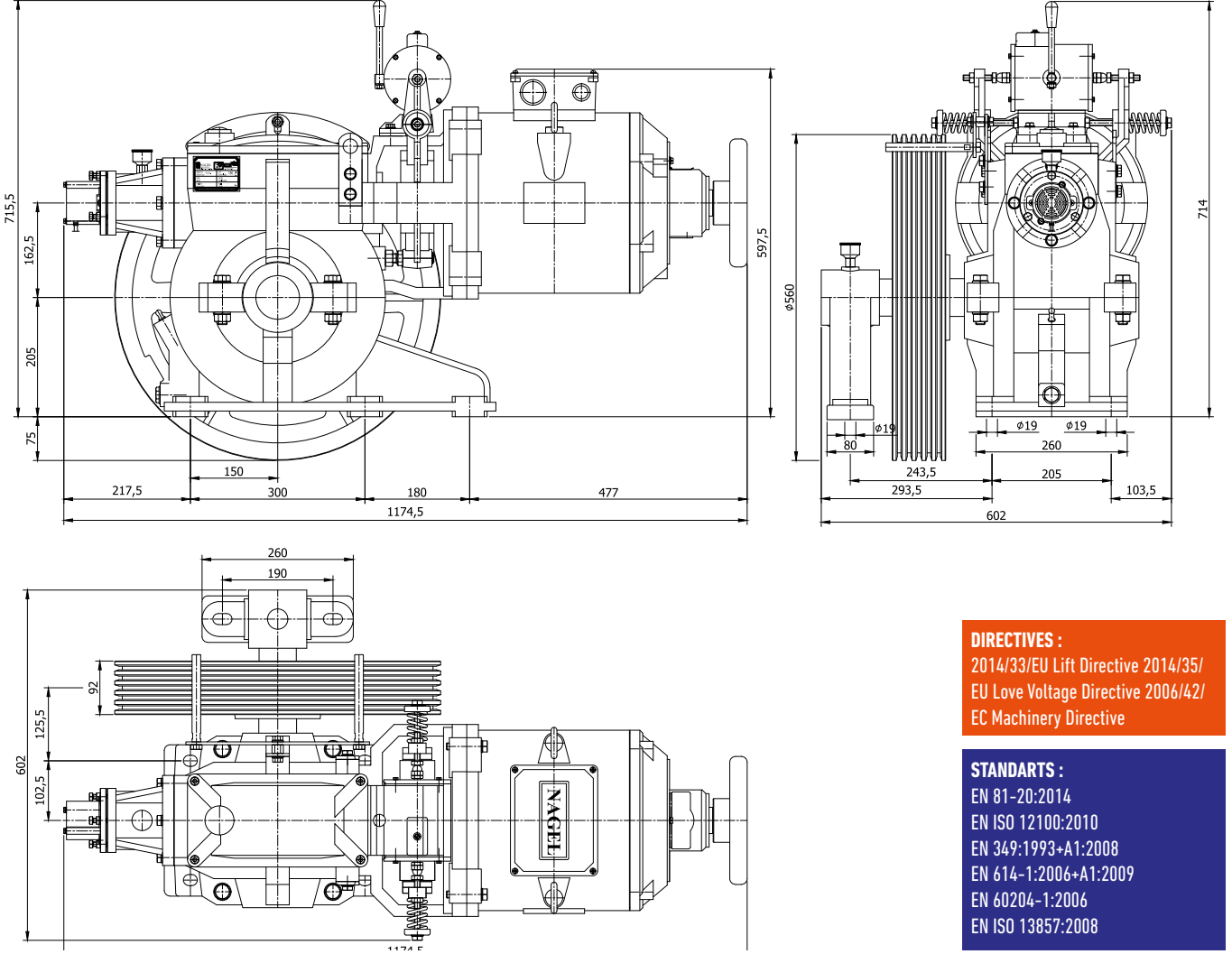

**DIRECTIVES :**  
 2014/33/EU Lift Directive 2014/35/  
 EU Low Voltage Directive 2006/42/  
 EC Machinery Directive

**STANDARDS :**  
 EN 81-20:2014  
 EN ISO 12100:2010  
 EN 349:1993+A1:2008  
 EN 614-1:2006+A1:2009  
 EN 60204-1:2006  
 EN ISO 13857:2008

| MAKİNE<br>MACHINE | MOTOR<br>MOTOR              | YÜK<br>LOAD | MOTOR kW<br>MOTOR kW | AKIM<br>CURRENT | HIZ<br>SPEED | ASKI<br>SUSPENSION | TAHVİL<br>RATIO | KASNAK<br>PULLEY | H. SAYISI x ÇAP<br>R. NUMBER x DIA. | STATİK YÜK<br>STATIC LOAD | SEYİR MESAFESİ<br>TRAVEL DISTANCE |
|-------------------|-----------------------------|-------------|----------------------|-----------------|--------------|--------------------|-----------------|------------------|-------------------------------------|---------------------------|-----------------------------------|
| ÖZGEN.4           | VVVF                        | 800 KG      | 9,2 kW               | 21 A            | 1 m/s        | 1 : 1              | 45 : 1          | 560 mm           | 5 x 10 mm                           | 6000 kg                   | 30 m (*60 m)                      |
| ÖZGEN.4           | VVVF                        | 1000 KG     | 10,3 kW              | 26 A            |              |                    |                 |                  |                                     |                           |                                   |
| ÖZGEN.4           | ÇİFT HIZ<br>DOUBLE<br>SPEED | 800 KG      | 9,2kW /<br>2,3kW     | 20 A<br>/17,5 A |              |                    |                 |                  |                                     |                           |                                   |
| ÖZGEN.4.2         | VVVF                        | 500 KG      | 7,5 kW               | 17 A            | 1,6 m/s      | 53:2               | 530 mm          |                  |                                     |                           |                                   |
| ÖZGEN.4.2         | VVVF                        | 630 KG      | 9,2 kW               | 20 A            |              |                    |                 |                  |                                     |                           |                                   |
| ÖZGEN.4.2         | VVVF                        | 800 KG      | 10,3 kW              | 26 A            |              |                    |                 |                  |                                     |                           |                                   |

Daha fazla ürün seçeneği için lütfen bizimle irtibata geçiniz.  
 Please contact us for more product options.

\* denge zinciri ile  
 \* with balance chain

# Özgen-4

Serisi / Series



**Not:**

- a) Tahrir kasnağı mil çapı Ø 64 mm
- b) Makine için önerilen yağ kullanılmaması,yatakların,dişlinin aşınmasına ve makine verim kaybına neden olur.
- c) Firmamız ürünlerinde haber vermeksizin değişiklik yapma hakkı saklıdır.

**Note:**

- a) Driving pulley shaft diameter is Ø 64 mm
- b) Recommended gear oil must be used otherwise the journal bearings and the gear will be worn out and the efficiency will decrease.
- c) We reserve the right to change the terms and conditions.



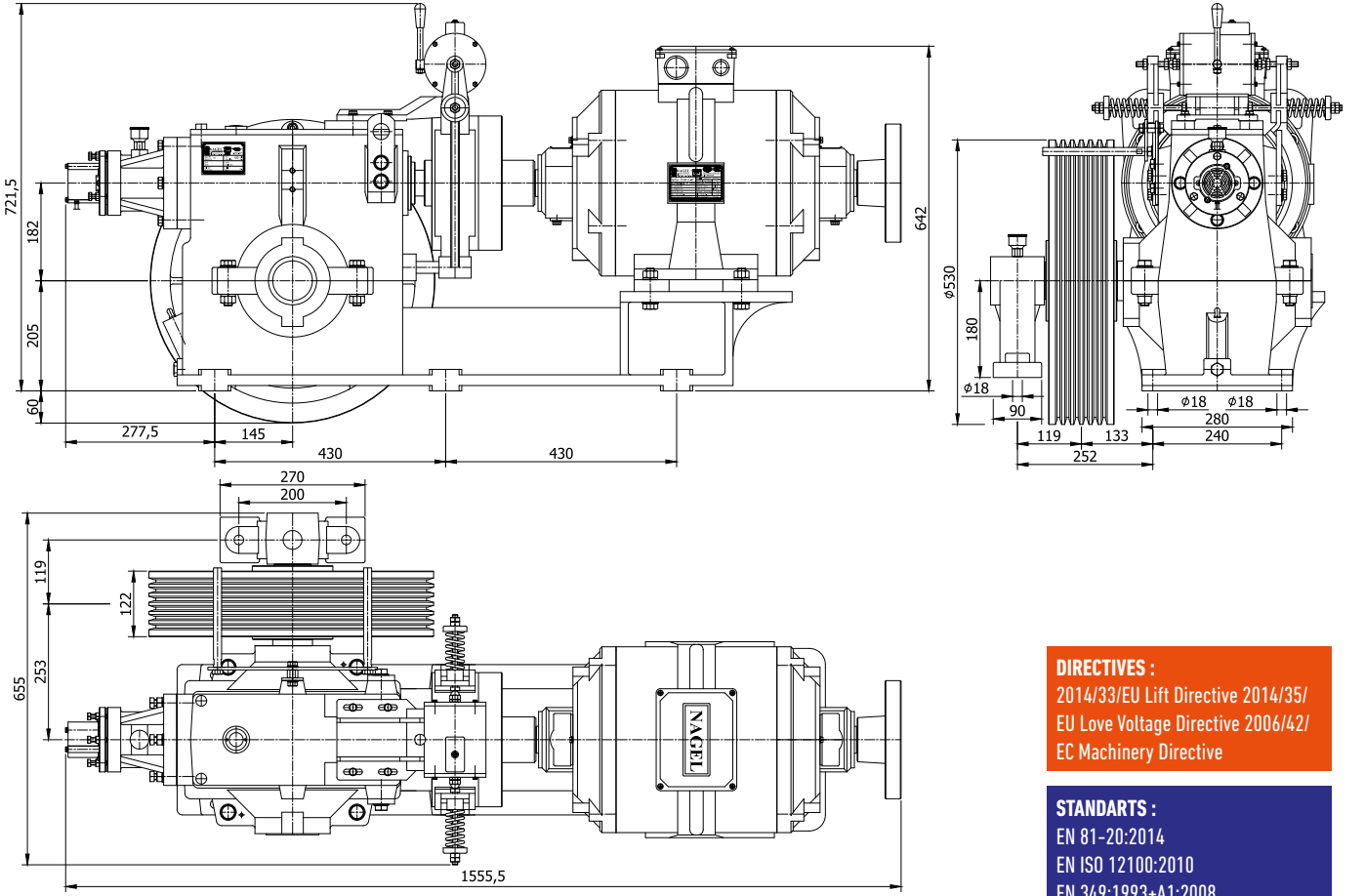

**DIRECTIVES :**  
 2014/33/EU Lift Directive 2014/35/  
 EU Low Voltage Directive 2006/42/  
 EC Machinery Directive

**STANDARTS :**  
 EN 81-20:2014  
 EN ISO 12100:2010  
 EN 349:1993+A1:2008  
 EN 614-1:2006+A1:2009  
 EN 60204-1:2006  
 EN ISO 13857:2008

| MAKİNE<br>MACHINE | MOTOR<br>MOTOR | YÜK<br>LOAD | MOTOR kW<br>MOTOR kW | AKIM<br>CURRENT | HIZ<br>SPEED | ASKI<br>SUSPENSION | TAHVİL<br>RATIO | KASNAK<br>PULLEY | H. SAYISI x ÇAP<br>R. NUMBER x DIA. | STATİK YÜK<br>STATIC LOAD | SEYİR MESAFESİ<br>TRAVEL DISTANCE |
|-------------------|----------------|-------------|----------------------|-----------------|--------------|--------------------|-----------------|------------------|-------------------------------------|---------------------------|-----------------------------------|
| ÖN.180            | VVVF           | 1250 KG     | 14,7 kW              | 31 A            | 0,8 m/s      | 1 : 1              | 50 : 1          | 530 mm           | 6 x 11 mm                           | 8000 kg                   | 30 m (*60 m)                      |
| ÖN.180            | VVVF           | 1500 KG     | 17,7 kW              | 38 A            |              |                    |                 |                  |                                     |                           |                                   |
| ÖN.180-2          | VVVF           | 1000 KG     | 13,2 Kw              | 28,3            | 1,6 m/s      | 1 : 1              | 59:2            | 600 mm           | 6 x 11 mm                           | 8000 kg                   | 30 m (*60 m)                      |
| ÖN.180-2          | VVVF           | 1200 KG     | 14,7 kW              | 31,6            |              |                    |                 |                  |                                     |                           |                                   |
| ÖN.180-2          | VVVF           | 1500 KG     | 17,7 kW              | 38,3            |              |                    |                 |                  |                                     |                           |                                   |

Daha fazla ürün seçeneği için lütfen bizimle irtibata geçiniz.  
 Please contact us for more product options.

\* denge zinciri ile  
 \* with balance chain

# Klasik-180

Serisi / Series

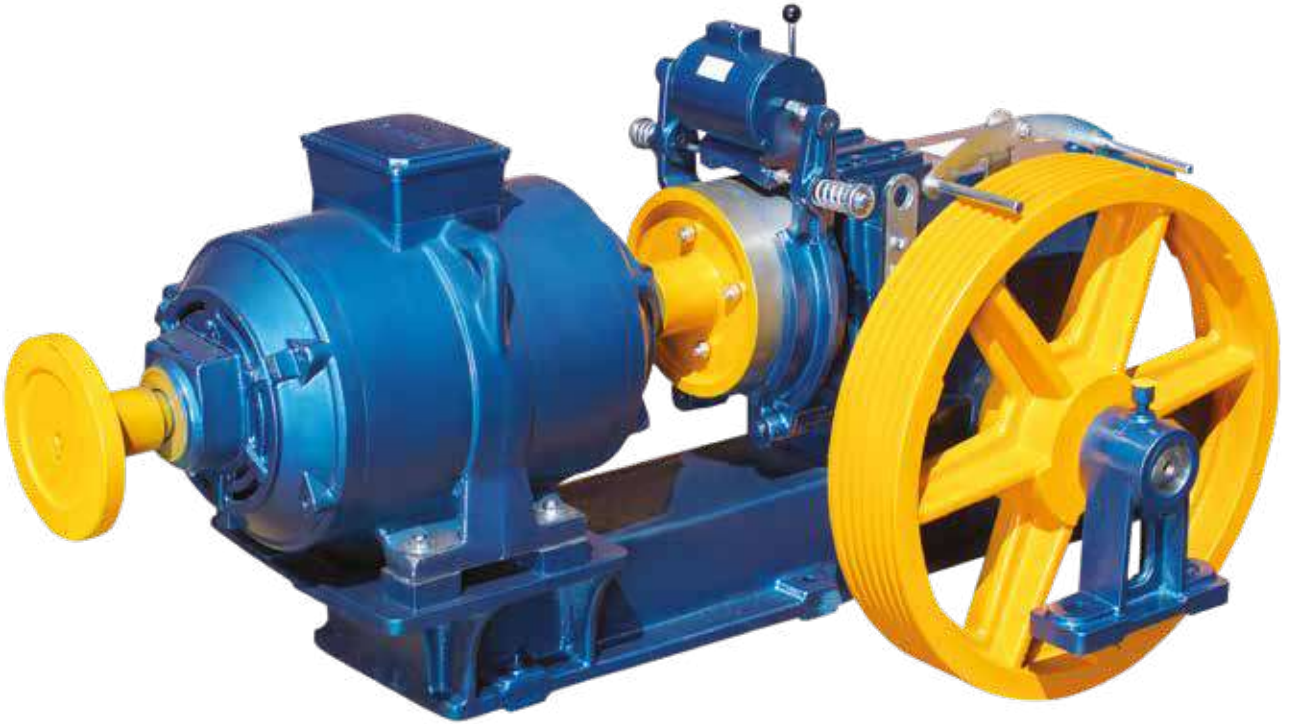

**Not:**

- a) Tahrik kasnağı mil çapı  $\varnothing$  70 mm
- b) Makine için önerilen yağ kullanılmaması, yatakların, dişlinin aşınmasına ve makine verim kaybına neden olur.
- c) 1,40 m/s sonrası hızlı makineler palangalı sistem içindir.
- d) Firmamız ürünlerinde haber vermeksizin değişiklik yapma hakkı saklıdır.

**Note:**

- a) Driving pulley shaft diameter is  $\varnothing$  70 mm
- b) Recommended gear oil must be used otherwise the journal bearings and the gear will be worn out and the efficiency will decrease.
- c) Above 1,40 m/s speed machines are for 2:1 roping systems.
- d) We reserve the right to change the terms and conditions.

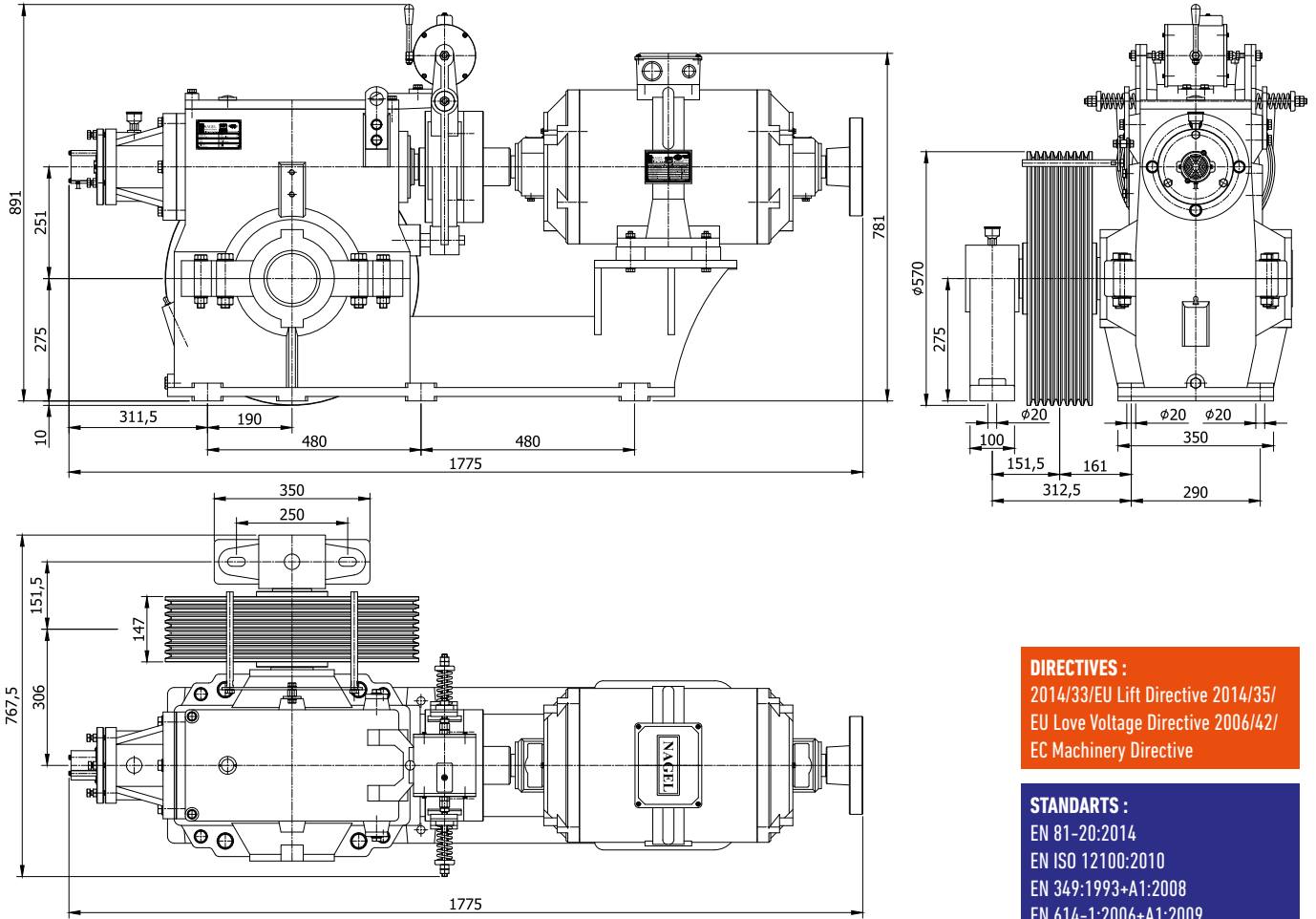

**DIRECTIVES :**

2014/33/EU Lift Directive 2014/35/  
 EU Low Voltage Directive 2006/42/  
 EC Machinery Directive

**STANDARDS :**

EN 81-20:2014  
 EN ISO 12100:2010  
 EN 349:1993+A1:2008  
 EN 614-1:2006+A1:2009  
 EN 60204-1:2006  
 EN ISO 13857:2008

| MAKİNE<br>MACHINE | MOTOR<br>MOTOR | YÜK<br>LOAD | MOTOR kW<br>MOTOR kW | AKIM<br>CURRENT | HIZ<br>SPEED | ASKI<br>SUSPENSION | TAHVİL<br>RATIO | KASNAK<br>PULLEY | H. SAYISI x ÇAP<br>R. NUMBER x DIA. | STATİK YÜK<br>STATIC LOAD | SEYİR MESAFESİ<br>TRAVEL DISTANCE |
|-------------------|----------------|-------------|----------------------|-----------------|--------------|--------------------|-----------------|------------------|-------------------------------------|---------------------------|-----------------------------------|
| ÖN.250            | VVVF           | 2000<br>KG  | 22 kW                | 50 A            | 0,8 m/s      | 1 : 1              | 50 : 1          | 570 mm           | 8 x 12 mm                           | 15000 kg                  | 30 m (*60 m)                      |
| ÖN.250            | VVVF           | 7000<br>KG  | 22 kW                | 50 A            | 0,2 m/s      | 4 : 1              |                 |                  |                                     |                           |                                   |

Daha fazla ürün seçeneği için lütfen bizimle iletişime geçiniz.  
 Please contact us for more product options.

\* denge zinciri ile  
 \* with balance chain

# Klasik-250

Serisi / Series



**Not:**

- a) Tahrir kasnađı mil apı Ø 90 mm
- b) Makine iin nerilen yađ kullanılmaması,yatakların,diřlinin aşınmasına ve makine verim kaybına neden olur.
- c) Firmamız rnlerinde haber vermeksizin deđiřiklik yapma hakkı saklıdır.

**Note:**

- a) Driving pulley shaft diameter is Ø 90 mm
- b) Recommended gear oil must be used otherwise the journal bearings and the gear will be worn out and the efficiency will decrease.
- c) We reserve the right to change the terms and conditions.





# Sertifikalar

## Certifications







e-katalog



[www.nagel.com.tr](http://www.nagel.com.tr)

Merkez - Fabrika / Head Office - Factory : Mecidiye Mah. Artvin Cad. No:70  
Sultanbeyli - İSTANBUL / TURKEY  
Tel. / Phone : +90 (216) 398 46 10  
+90 (216) 398 07 46  
+90 (216) 419 78 68  
Faks / Fax : +90 (216) 398 11 36



/nagelmakinemotor